

# Quick Start

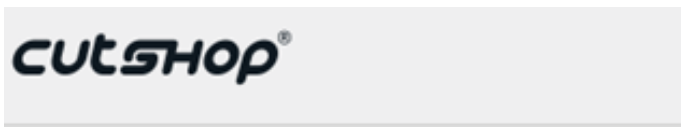

A get-you-started guide to ordering your cut-to-size cabinetry online.

## 1 Create a new job



Good morning, 'Customer name'



## 2 Select collection or delivery

How would you like to receive your order?

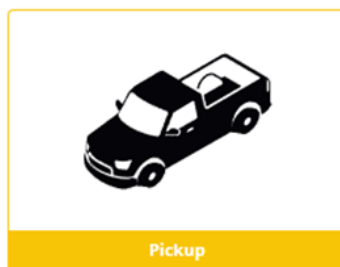

Current selection  
47 Northway St  
Hamilton, 3200



### 3 Add defaults to a new 'Room'

Step 1

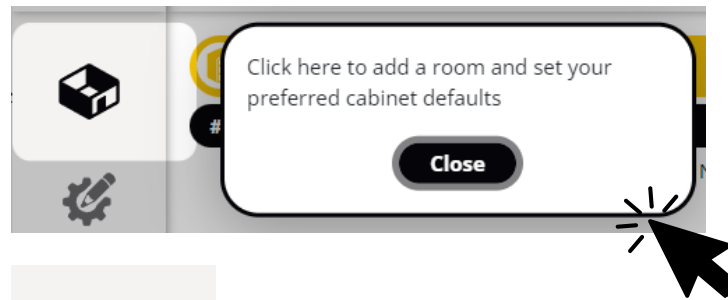

Step 2

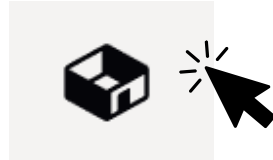

Step 3

#### Add and name your room

Colour and hardware choices are set by room, update these defaults to your preference.

See the 'HowTo' below to set the more advanced items

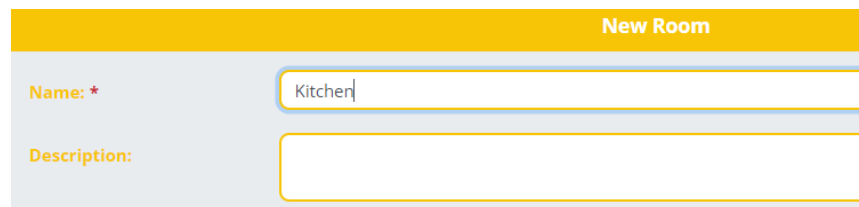

Step 4

#### The fun part, select your interior & exterior colours!

All selected product selections will automatically become your default option for this room.

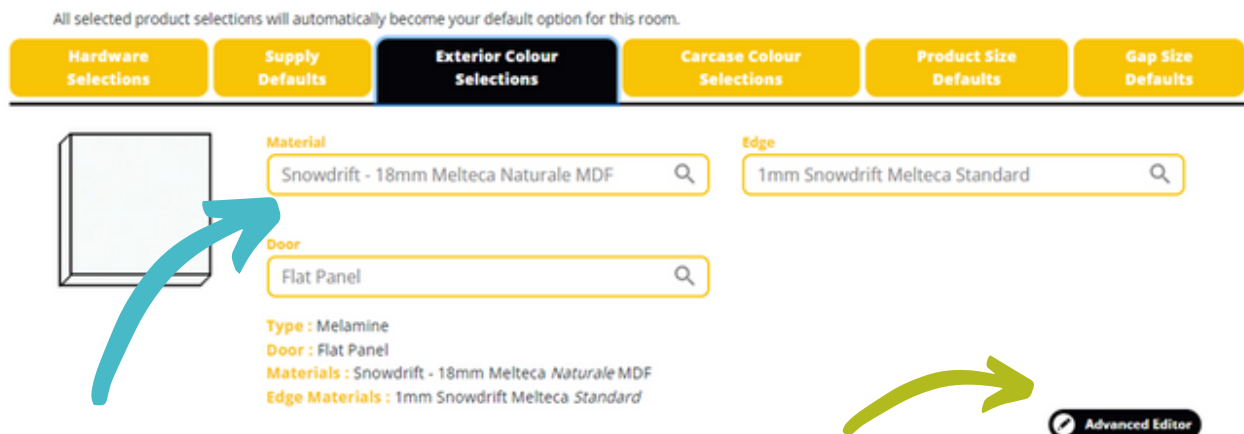

Hardware Selections | Supply Defaults | **Exterior Colour Selections** | Carcase Colour Selections | Product Size Defaults | Gap Size Defaults

Material: Snowdrift - 18mm Melteca Naturale MDF

Edge: 1mm Snowdrift Melteca Standard

Door: Flat Panel

Type: Melamine  
Door: Flat Panel  
Materials: Snowdrift - 18mm Melteca Naturale MDF  
Edge Materials: 1mm Snowdrift Melteca Standard

Advanced Editor

If you'd like to supply your own board for us to cut and edge - no problem!

Type **"Customer Supply"** into the material box.

Use the **Advanced Editor** visually select a colour.

Step 5



## 4 Select cabinets or panels

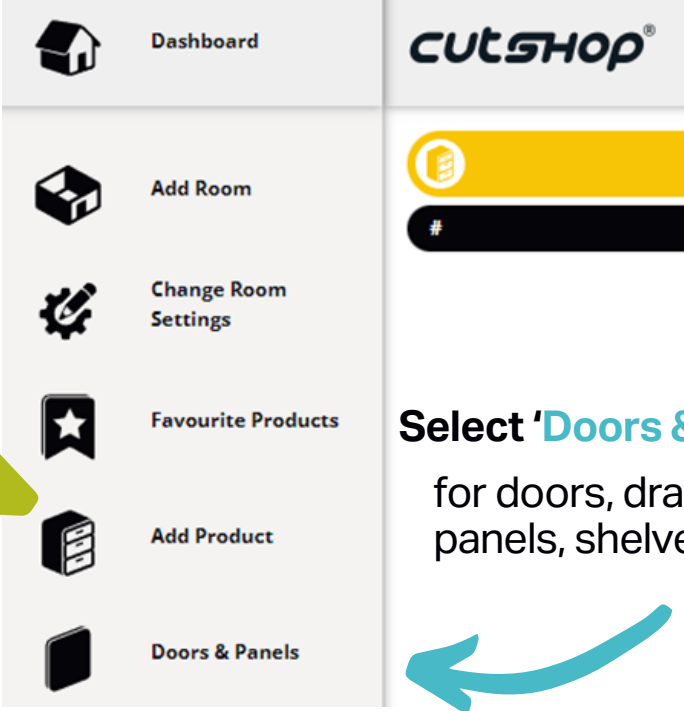

The screenshot shows the CUTSHOP mobile app interface. On the left is a navigation menu with the following items: Dashboard (house icon), Add Room (box icon), Change Room Settings (gears icon), Favourite Products (star icon), Add Product (cabinet icon), and Doors & Panels (panel icon). On the right is the main content area with the CUTSHOP logo at the top, a yellow bar with a cabinet icon, and a black bar with a hash symbol. A green arrow points from the text 'Select 'Add Product' for customisable premade cabinets' to the 'Add Product' menu item. A blue arrow points from the text 'Select 'Doors & Panels' for doors, drawers, end panels, shelves etc.' to the 'Doors & Panels' menu item.

**Select 'Add Product'**  
for customisable  
premade cabinets

**Select 'Doors & Panels'**  
for doors, drawers, end  
panels, shelves etc.

## 5 Submit the job

**We'll check it out for any anomalies and send you the information for payment, after this point – no changes can be made.**

Your work is done, we'll be in touch with an expected completion date!

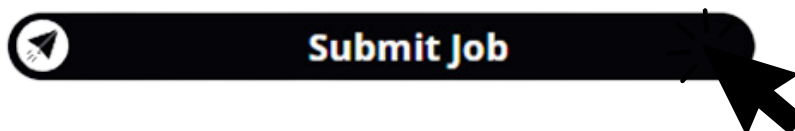

# How To

Update the default settings.

## 1 Add and name your room

Colour and hardware choices are set by room. Add and name your room to update these defaults to your preference.

**New Room**

Name: \*

Description:

## 2 Hardware selections

Use the dropdown boxes to update your hardware preferences.



Select your default hinge style: \*

Blum Inserta Soft Close



Select your default drawer style: \*

Tekform Double Wall 40kg

- Alto 35Kg (drill only)
- Blum Antaro 30kg
- Blum Antaro 65kg
- Blum Metabox Soft Close
- Blum Movento For Wood
- Blum Tipon Antaro 30Kg
- Blum Tipon Antaro 65Kg



Select your default cabinet top (base cabinets): \*

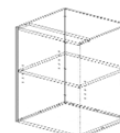

### 3 Supply defaults

Configure how would you like to receive the job.

#### Select Assembled

If you'd prefer to receive your cabinets assembled instead of flat pack.

#### Select Drill Panels Only

If you'd prefer to source your own hardware instead of being supplied.

#### Select Adjustable Legs

We recommend you keep Adjustable Legs selected, unless you're a professional.



Includes carcasses screwed together, hardware and doors affixed. Does not include installation or applied panel and toe-kicks being attached.

Assembled



Individual componentry packed flat and loaded onto a pallet or similar which is wrapped in plastic film.

Flat Pack



Includes the supply of hinges and drawers applicable to the products selected. Includes screws and shelf studs.

Supply Hardware



Supply of cut, edged and drilled panels only. Inclusive of screws to assemble cabinets.

Drill Panels Only (no hardware supplied)



Adjustable from 90mm to 180mm

Adjustable Legs



No Adjustable Legs

### 4 Colour selections

The fun part, select your interior & exterior colours!

All selected product selections will automatically become your default option for this room.

Hardware Selections	Supply Defaults	Exterior Colour Selections	Carcase Colour Selections	Product Size Defaults	Gap Size Defaults
		<div style="display: flex; align-items: flex-start;"><div style="margin-right: 10px;"></div><div><p><b>Material</b></p><input type="text" value="Snowdrift - 18mm Melteca Naturale MDF"/> <p><b>Door</b></p><input type="text" value="Flat Panel"/> <p>Type : Melamine Door : Flat Panel Materials : Snowdrift - 18mm Melteca <i>Naturale</i> MDF Edge Materials : 1mm Snowdrift Melteca <i>Standard</i></p></div></div>	<div style="display: flex; align-items: flex-start;"><div style="margin-right: 10px;"><p><b>Edge</b></p><input type="text" value="1mm Snowdrift Melteca Standard"/></div></div>		

[Advanced Editor](#)

If you'd like to supply your own board for us to cut and edge - no problem! Type "customer supply" into the material box.

Use the Advanced Editor to visually select a colour.

## 5 Product size defaults

Pro's only! Configure the default product sizes of units here.



## 6 Gap size defaults

Pro's only! Configure the default gap sizes of units here.



## 7 Save room

**Remember to save!**

Once you've done this, any cabinets, doors and panels you add to THIS ROOM will get these settings! Easy-As!

